



# Fencing & Decking

## Branch Network

### Antrim

Springfarm Ind Estate  
BT41 4NT  
T 028 9448 1352

### Belfast Rosetta

72 Knockbreda Road  
BT6 0JB  
T 028 9064 1235

### Craigavon

42A Seagoe Ind Estate  
BT63 5QE  
T 028 3833 5723

### L'Derry

Unit 2B Altnagelvin Ind Estate  
BT47 2ED  
T 028 7134 8348

### Ballymoney

24 Ballybrakes Road  
BT53 6LQ  
T 028 2766 4742

### Belfast MacBlair Paint

93 York Road  
BT15 3GY  
T 028 9075 1217

### Downpatrick

20 Church Street  
BT30 6ER  
T 028 4461 6325

### Douglas Isle of Man

Unit 5 Middle River Ind Estate  
IM2 1AL  
T 016 2467 1118

### Bangor

70 Balloo Road  
BT19 7PG  
T 028 9127 1792

### Coleraine MacBlair Plumbing

5 Loguestown Ind Estate  
BT52 2NS  
T 028 7034 4422

### Eglinton

15 Killylane Road  
BT47 3DW  
T 028 7181 0233

### Belfast Boucher

4 Balmoral Road  
BT12 6QA  
T 028 9055 1379

### Coleraine

5 Loguestown Ind Estate  
BT52 2NS  
T 028 7034 4751

### Larne

52 Circular Road  
BT40 3AB  
T 028 2827 2031

### Belfast Duncrue

42-44 Duncrue Crescent  
BT3 9BW  
T 028 9037 0357

### Cookstown

Sandholes Road  
BT80 9AR  
T 028 8676 2211

### Lisburn

38 Young Street  
Lisburn BT27 5EB  
T 028 9262 7499

## MacBlairCivils

**Belfast** Boucher

## MacBlairPlumbing

**Antrim**

**Bangor**

**Belfast** Boucher

**Belfast** Duncrue

**Coleraine**

**Cookstown**

**Eglinton**

**Larne**

## MacBlairHire

**Antrim**

**Bangor**

**Belfast** Boucher

**Belfast** Duncrue

watershed  
BATHROOMS & TILES

**Antrim**

**Bangor**

**Belfast** Boucher

**Coleraine**

**Cookstown**

**Eglinton**

**Larne**

# MacBlair

Your **LOCAL** Builders' Merchant

Find your **LOCAL** branch at

**MacBlair.com**



# FENCE PANELS



**Causeway Fence Panel**

97134 1.8m x 1.8m

\*Matching gates available



**Rathlin Fence Panel**

97152 1.2m x 1.8m

97138 1.8m x 1.8m

\*Matching gates available



**Square Horizontal Fence Panel**

97155 1.2m x 1.8m

97154 1.8m x 1.8m

\*Matching gates available



**Overlay Fence Panel**

97100 0.9m x 1.8m

97101 1.2m x 1.8m

97102 1.5m x 1.8m

97103 1.8m x 1.8m



**Double Sided Paling Panel**

97424 1.2m x 1.8m

97423 1.8m x 1.8m



**Diamond Fence Panel Rectangle**

99426 0.3m x 1.83m

99427 0.6m x 1.83m

99428 0.9m x 1.83m

99429 1.8m x 1.83m

99425 0.3m x 1.83m

\*Convex



## FENCE TRELLIS



RECTANGLE

### Rectangle Trellis

97105	0.3m x 1.8m
99422	0.6m x 1.8m
97120	0.9m x 1.8m
97119	1.0m x 1.8m
97104	1.8m x 1.8m



CONVEX

CONCAVE

### Convex/Concave Trellis

97165	0.3m x 1.8m
97131	0.6m x 1.8m
97162	0.9m x 1.8m
97163	1.2m x 1.8m
97130	1.8m x 1.8m



## GATES & ARCHES



### Arched Horizontal Gate

99434 0.9m x 1.8m

\*Matches Causeway Fence Panel



### Square Horizontal Gate

99435 0.9m x 1.8m

\*Matches Square Horizontal Fence Panel

We strongly recommend using heavy duty hinges with this gate



### Arched Lattice Top Gate

99434 0.9m x 1.8m

\*Matches Rathlin Fence Panel



### Omega Top Arch

99430 0.6m x 1.25m x 2.6m

\*Please note arch height is given prior to in-ground placement



# FENCE BOARDS AND RAILS



## Fence Board Treated

97087	22mm x 144mm x 0.6m
97010	22mm x 144mm x 0.9m
97020	22mm x 144mm x 1m
97021	22mm x 144mm x 1.2m
97048	22mm x 144mm x 1.5m
97022	22mm x 144mm x 1.6m
97023	22mm x 144mm x 1.8m
97011	22mm x 144mm x 2.0m
97012	22mm x 144mm x 2.1m
97025	22mm x 144mm x 2.4m
97027	22mm x 144mm x 3.0m
97006	22mm x 144mm x 3.8m



## Fence Board Treated Round

97019	22mm x 144mm x 1m
97013	22mm x 144mm x 1.2m
97060	22mm x 144mm x 1.5m
97086	22mm x 144mm x 1.8m
97091	22mm x 144mm x 2.4m
97065	22mm x 94mm x 1800mm



## Fence Board Splayed Rail

97016	50mm x 75mm x 3.6m
97053	50mm x 75mm x 4.2m
97017	50mm x 75mm x 4.8m



## Fence Board D Rail

97015	32mm x 94mm x 3.6m
97052	32mm x 94mm x 4.2m
97177	32mm x 94mm x 4.8m
97176	32mm x 144mm x 3.6m
97059	32mm x 144mm x 4.2m
97081	32mm x 144mm x 4.8m



# FENCE POSTS & RAILWAY SLEEPERS



## Fence Posts Unpointed Treated

97030	75mm x 75mm x 1.5m
97033	75mm x 75mm x 1.8m
97031	75mm x 75mm x 2.1m
97034	75mm x 75mm x 2.4m

97036	100mm x 100mm x 1.5m
97037	100mm x 100mm x 1.8m
97038	100mm x 100mm x 2.1m
97040	100mm x 100mm x 2.4m
97041	100mm x 100mm x 3.0m



## Fence Posts Pointed Treated

97063	75mm x 75mm x 1.5m
97064	75mm x 75mm x 1.8m
97067	75mm x 75mm x 2.1m
97062	75mm x 75mm x 2.4m



## Timber Railway Sleeper Treated

97003	200mm x 100mm x 2.4m
97005	100mm x 200mm x 3.0m



## Timber Railway Sleeper Reclaimed

97004	2.75m (Width and Depth may vary)
-------	----------------------------------

## GARDEN FURNITURE





# DECKING



## Treated Decking

- 101170 28mm x 144mm x 3.6m
- 101179 28mm x 144mm x 3.9m
- 101174 28mm x 144mm x 4.4m
- 101171 28mm x 144mm x 4.8m

## Decking Spindle

- 101003 41mm x 41mm x 0.9m (Square)
- 101005 41mm x 41mm x 0.9m (Turned)

## Decking Handrail

- 101175 34mm x 77mm x 3.6m
- 101177 34mm x 77mm x 4.4m

## Decking Baserail

- 101176 32mm x 78mm x 3.6m
- 101178 32mm x 78mm x 4.2m

## Decking Posts

- 101048 94mm x 94mm x 1.8m
- 101049 94mm x 94mm x 2.4m
- 101090 94mm x 94mm x 3.0m

## Treated Decking Posts

- 105500 45mm x 100mm x 1m
- 105525 45mm x 150mm x 1m

## Glenariff Decking Panel

- 97139 900mm x 1.8m





# DECKING



## GrasseDeck Treated Decking

101172 28mm x 144mm x 4.5m

632395 28mm x 144mm x 4.5m

\* GrasseDeck brings a new dimension to standard decking, creating a softer aesthetic and working well in contrast to hard landscaping materials. DeckMark approved, PEFC certified and has a 15 year guarantee against rot and fungal decay, subject to correct installation and treatment of cut timber



## Walksure

101173 28mm x 120mm x 3.6m

101180 28mm x 120mm x 4.2m

\* Walksure slip resistant product provides a safe slip resistant surface in wet or dry conditions. GrasseDeck decking is DeckMark approved, PEFC certified and has a 15 year guarantee against rot and fungal decay, subject to correct installation and treatment of cut timber.



## Newel Posts

101008 1.5m (Patrice)

101007 1.5m (Colonial)

99843 94mm x 94mm x 1.5m (Colonial)

110579 1.2m (Square Patrice)

99845 82mm x 82mm x 1.195m (Colonial)

99844 94mm x 94mm x 1.5m (Deck Pat)

99846 82mm x 82mm x 1.195m (Deck Pat)



## Post Caps

97107 75mm x 75mm

97108 100mm x 100mm

## GENERAL GUIDE TO CONSTRUCTING A DECK.

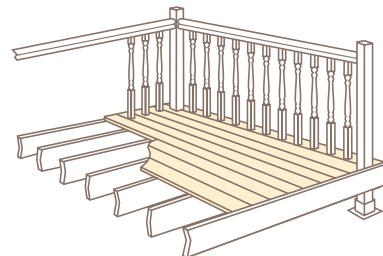

1. Prepare the site.
2. Make the framework using floor joist.
3. Fix treated decking boards onto framework using galvanised screws or nails.
4. If desired add spindles and handrails.
5. Finish project using Woodstain and Wood Preservative.  
See pages 12 and 13 for our range.

FOR DETAILED INSTRUCTIONS VISIT  
[WWW.METSAWOOD.CO.UK](http://WWW.METSAWOOD.CO.UK)

## ACCESSORIES - IRONMONGERY



### Decking Screws

4045	M4.5 x 50mm (Qty. 200 per box)
4047	M4.5 x 60mm (Qty. 200 per box)
4046	M4.5 x 75mm (Qty. 100 per box)



### Padbolts

18308	2A 100mm Galvanised
18309	2A 150mm Galvanised
18310	2A 200mm Galvanised
18312	1A 300mm Galvanised



### Galvanised Nails

4045	M4.5 x 50mm (Qty. 200 per box)
4047	M4.5 x 60mm (Qty. 200 per box)
4046	M4.5 x 75mm (Qty. 100 per box)



### Corner Brace

4045	M4.5 x 50mm (Qty. 200 per box)
4047	M4.5 x 60mm (Qty. 200 per box)
4046	M4.5 x 75mm (Qty. 100 per box)

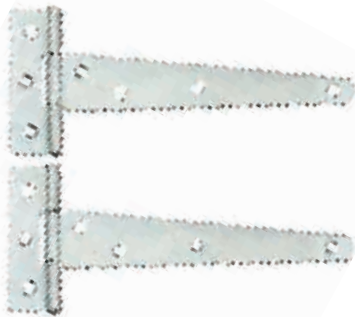

### Tee Hinges (Heavy)

9612	100mm ZP
9616	150mm ZP
9617	230mm ZP
9618	300mm ZP
9619	375mm ZP



### Tee Hinges (Japd)

9630	100mm Pair
9631	150mm Pair
9632	230mm Pair

ACCESSORIES - IRONMONGERY



**Bow Handle Bolt (Japd)**

18317     300mm  
18319     4500mm

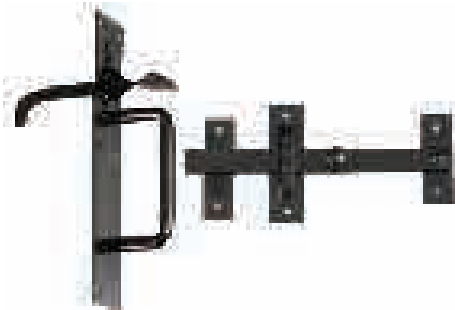

**Suffolk Latch 20/2 (Japd)**

20900



**Terry 477 Gate Spring (Japd)**

29911     250mm



**Monkey Tail Bolt (Japd)**

18313     60MT 300mm  
18314     60MT 381mm  
18315     60MT 450mm  
18316     60MT 600MM



**Tower Bolt (Japd)**

18299     75mm  
18300     100mm  
18301     150mm  
18302     200mm

**Tower Bolt**

18305     100mm  
18303     150mm  
18306     200mm



**Cabin Hook (Japd)**

36603     100mm  
36604     150mm  
36605     20mm

**Cabin Hook**

36600     152mm

# ADHESIVES



**Rapid Set Concrete**  
290722 20Kg

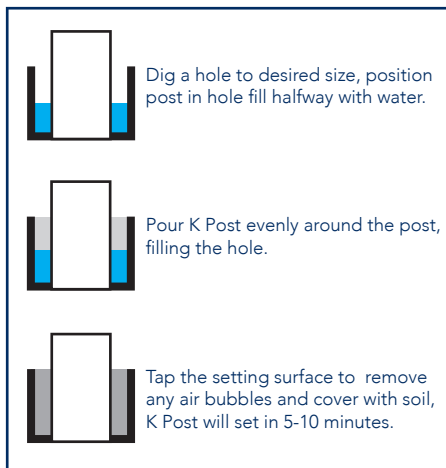

**Fencefix Post Support Bolt down**  
58323 75mm x 75mm  
58234 100mm x 100mm



**Fencefix Post Support Drive In Spike**  
58325 75mm x 75mm  
58327 100mm x 100mm

Make your project easier by using our in house Hire Service- **MacBlair Hire**. Pick up your 100 page copy in store.



**One Man Post Hole Borer - Petrol**  
Perfect for making holes in loose sub-soils for fence posts. Comes with 200mm auger.



**Manual Post Hole Borer**  
suitable for soft ground when installing small fences.



**Post Rammer**  
Drives posts directly into the ground, one or two man operation.



# PAINT AND PROTECTION



## Ronseal One Coat Fencelife

424931	4Lt + 25% Free *Dark Oak
424932	4Lt + 25% Free *Medium Oak
424933	4Lt + 25% Free *Red Cedar
424934	4Lt + 25% Free *Forest Green
424935	4Lt + 25% Free *Harvest Gold
424936	4Lt + 25% Free *Black Tudor
424939	4Lt + 25% Free *Country Oak



## Ronseal Decking Stain

425440	2.5Lt * Golden Cedar
425441	2.5Lt *Rich Mahogany
424954	2.5Lt * Rich Teak
425288	2.5Lt *Country Oak
425560	2.5Lt *Rustic Pine



## Ronseal Decking Oil

425442	2.5Lt *Natural
425453	2.5Lt *Natural Pine
425454	2.5Lt * Natural Cedar
425455	2.5Lt *Natural Oak
425456	2.5Lt *Natural Mahogany



## Ronseal Decking Oil

424953	5.0Lt *Natural Mahogany
425522	5.0Lt *Natural
425556	5.0Lt * Natural Oak
425557	5.0Lt *Natural Cedar
425558	5.0Lt *Natural Pine

This durable scuff resistant tinted oil forms a waterproof barrier to protect against weathering, warping, swelling, drying and splitting. It resists both algae growth and mould and its fade resistant finish protects against UV rays. It is suitable for use on hardwood and softwood decking and fencing.



## Larsen Wood Preservative

293055	2.5Lt *Brown
293059	2.5Lt *Green
293711	2.5Lt * Clear
293706	5.0Lt *Brown
293701	5.0Lt *Green
293704	5.0Lt *Clear



**Larsen Brick  
& Patio Cleaner**  
293454 5.0Lt



**Sika Mould Buster**  
272194 5.0Lt



**Karcher Pressure Washer**

## ACCESSORIES

**DON'T FORGET  
THE ACCESSORIES**



**Tala Claw Hammer F/Glass Handle**  
69303



**Bahco 244 Handsaw 550mm**  
69408



**Hammerlin Builders Wheelbarrow**  
191707



**Builders Wheelbarrow Galvanised**  
191710 85Lt



**Top Soil**  
616982 Bulk bag



**Gallup Weed Killer**  
7483 5Lt



**Landscaping Fabric**  
270931 1m x 15m Roll  
622252 2m x 100m Roll



**Ronseal 'The Big Brush'**  
439711 100mm

# TRADEMARKS AND MEASUREMENT GUIDES



Forest Stewardship Council facilitates the development of standards, ensures monitoring of certified operations and protects the FSC trademark so consumers can choose products that come from well managed forests.



The Programme for the Endorsement of Forest Certification (PEFC) is the world's largest forest certification system. Our credible standards seek to transform the way forests are managed globally – and locally - to ensure that all of us can enjoy the environmental, social and economic benefits that forests offer.



The DeckMark® Certification Scheme is a third party product quality certification scheme operated by the Timber Decking Association (TDA). The scheme is based on recognised quality assurance standards (ISO 9000) and confirms compliance to good manufacturing practices and relevant British Standards and ensures that any Metsä Wood decking product is of the highest standard.



Responsible Purchasing Network (RPN) is an international network of buyers dedicated to socially responsible and environmentally sustainable purchasing. Our membership program and consulting services provide institutional purchasers with cutting edge procurement tools and resources designed to save money, conserve resources, reduce waste, and improve efficiency.

## Metric/Imperial Conversion

MM	IN	M	FT & IN
25	1	0.9	2' 11 1/2"
32	1.25	1.05	3' 5 1/2"
38	1.5	1.2	3' 11"
50	2	1.5	4' 11"
60	2.5	1.8	5' 10 1/2"
75	3	1.83	6'
100	4	2.1	6' 10"
125	5	2.4	7' 10"
150	6	2.7	8' 10"
175	7	3.0	9' 10"
200	8	3.3	10' 9 1/2"
250	10	3.6	11' 9 1/2"
300	12	3.9	12' 9 1/2"
400	16	4.2	13' 9"
500	20		
600	24		

## Roll Lengths

M	FT & YDS
4.55	15 <sup>FT</sup> 5 <sup>YDS</sup>
6	20 <sup>FT</sup>
9.1	30 <sup>FT</sup> 10 <sup>YDS</sup>
10	32 <sup>FT</sup>
12.5	41 <sup>FT</sup>
25	82 <sup>FT</sup>
30	98 <sup>FT</sup>

## Delivery Service

Let us take the hassle out of your Self Build project with the use of our Delivery Service. Our large fleet of lorries can deliver all large products such as Cement, Plasters, Plasterboard, Insulation and Drainage. All delivery vehicles are equipped with mechanical handling equipment to ensure fast and efficient off loading at your site.

Ask in store for details.



