

Engineering Brick

cat 30/50 engineered (frogged) concrete brick with a smooth finish

DEPTHS



65
Millimetres

FINISH

SM
Smooth

215 x
102.5 mm

Engineering
colours

COLOURS



CAT 30

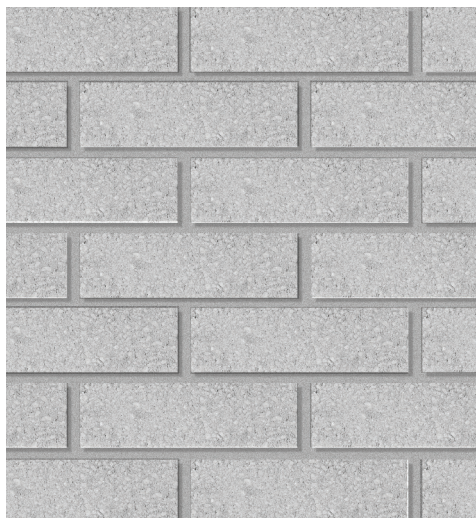

CAT 50



Frost
Resistant



Very Low
Water
Absorption



Engineering Brick

cat 30/50 engineered (frogged) concrete brick with a smooth finish

Engineering
Technical Information

DEPTHS



65
Millimetres

FINISH

SM
Smooth

215 x
102.5 mm

STANDARDS + PERFORMANCE

Manufactured in accordance with BS EN 771-3: 2011

Specification in accordance with BS EN 771-3: 2011

SUSTAINABILITY

Energy Use	100% renewable
Water Used	90% rain water harvesting
Recyclable	100% of this product can be recycled
Manufacturing	Produced in the UK from locally sourced materials
Waste Wood + Plastic:	100% recycled
Carbon Footprint	We have a new state-of-the-art washing plant which enables AG to produce bricks from 100% reclaimed waste aggregate. Please contact our Technical Specification Department if you are interested in specifying such a product.
BREEAM	'A' Rating – in accordance with the BRE Green Guide to Specification.

Information for a specific colour is available on request from our Technical Specification Department.

ADVICE + GUIDANCE

For advice and guidance on ordering, installation, good site practice, etc. visit our website:

professional.ag.uk.com/advice+guidance

For maintenance guidance and health and safety advice visit our website:

professional.ag.uk.com/maintenance

FEATURES + BENEFITS

- Can be used for building up manholes
- Can be used internally for generator rooms.
- Manufactured in a controlled environment.
- Features a frog to assist with shear key to the mortar.
- Very low occurrence of efflorescence.
- Dimensionally accurate.
- Low wastage levels.
- Frost resistant.

AG RECOMMENDATIONS

Frog

Engineering bricks should be laid with the frog facing upwards and completely filled with mortar.

Mortar Ratio

Recommended ratio 6 : 1 or 5 : 1 (Sand : OPC).

EDGES

Engineered brick is supplied with crisp, clean, sharp edges

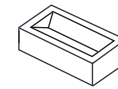

FINISHES

Engineered Brick comes in a smooth finish for a contemporary feel.



Frost
Resistant



Very Low
Water
Absorption

SPECIFICATION REFERENCE: NBS PLUS: F10 BRICK/ BLOCK WALLING 215 CONCRETE FACING BRICKWORK BS EN 771-3: 2011

Engineering Brick

cat 30/50 engineered (frogged) concrete brick with a smooth finish

DEPTHS



65
Millimetres

FINISH

SM
Smooth

215 x
102.5 mm

Engineering
stock information



Frost
Resistant



Very Low
Water
Absorption

STOCK INFORMATION

Product type	Length (mm)	Depth (mm)	Height (mm)	In Stock	Available Colours	Units per pack	Unit weight (kg)	Weight per pack (t)	Packs per 8 wheeler	Packs per unit lorry
CAT 30 (with frog)	215	100	65	Yes	Grey Smooth	512	2.9 kg	1.7 t	10	15
CAT 50 (with frog)	215	100	65	MTO	Grey Smooth	512	2.9 kg	1.7 t	10	15

NB. In stock items requiring over 10,000 no. bricks are treated as made to order.

MTO - made to order (minimum order size 10,000 no. bricks).

Cat 30 and Cat 50 are not supplied on pallets. Pallets are available on request.

All size dimensions are nominal.

TECHNICAL INFORMATION

	Cat 30	Cat 50
MANUFACTURING STANDARD	BS EN 771-3: 2011+A1 : 2015 Attestation Level 2+	
COMPRESSIVE STRENGTH*	Min average 30N / mm ²	Min average 50N / mm ²
WATER ABSORPTION	5% max	5% max
DURABILITY DESIGNATION	F2 Severe Exposure	F2 Severe Exposure
MEAN COEFFICIENT OF WATER ABSORPTION	1.5 g / (m ² .s)	1.5 g / (m ² .s)
MOISTURE MOVEMENT COEFFICIENT**	0.46 mm / m	0.46 mm / m
ACTIVE SOLUBLE SALTS [SO3]	0.03%	0.03%
SIZE TOLERANCE	BS EN 771-3: 2011 (T1) Category D3	
GROSS DENSITY	2200-2300 Kg / m ³	2200-2300 Kg / m ³
THERMAL CONDUCTIVITY	1.56 W / m.K	1.56 W / m.K

	Cat 30	Cat 50
INITIAL RATE OF ABSORPTION	0.42 Kg / m ² .m-1	0.42 Kg / m ² .m-1
BOND STRENGTH	0.15 N / mm ²	0.15 N / mm ²
REACTION TO FIRE	A1 Class	A1 Class
TYPE OF MORTAR	Recommended ratio 6 : 1 or 5 : 1 Sand : OPC	Recommended ratio 6 : 1 or 5 : 1 Sand : OPC
WATER VAPOUR PERMEABILITY [u]	5 / 15u tabulated from EN 1745	5 / 15u tabulated from EN 1745
PACK QUANTITY	512	512
PACK SIZE [APX. MM]	L 850 x D 850 x H 1100mm	L 850 x D 850 x H 1100mm
TYPICAL PACK WEIGHT	1700 Kg	1700 Kg
PACKAGING (FULL SHRINK BAG)	Unpalletted***	Unpalletted***

* Compressive strength in accordance with PD 6697 : 2010 and Eurocode 6.

** Determination of moisture movement and drying shrinkage carried out in accordance with BS EN 772-14:2001 (E)

*** Pallets are available on request.

MANUFACTURING

Engineering bricks are manufactured by using advanced manufacturing processes and natural materials. All products are manufactured from natural materials and although we strive to provide consistency of colour, variation may occur in the manufacturing process - this applies to all concrete products within the industry. PLANT OF MANUFACTURE (POM): Made at our Fivemiletown Production Plant.

CERTIFICATION

ISO 9001
ISO 14001
ISO 45001
CE Marking

Quality Management.
Environmental Management.
Occupational Health and Safety Management.
Download our Declaration of Performance (DOP) data at: www.ag.uk.com/cemarking