

Warm-R

Graphite Enhanced EPS

Product Specifications

External Wall Insulation Board EWB/EPSP

Walls: Enhanced EPS

Key Features

Extensive Range of
Sizes and Thicknesses

Thermal Conductivity
of 0.031 W/mk

BRE Green Guide A Rated

Manufactured without
the use of CFC's/HCFC's

Zero ODP and GWP <5

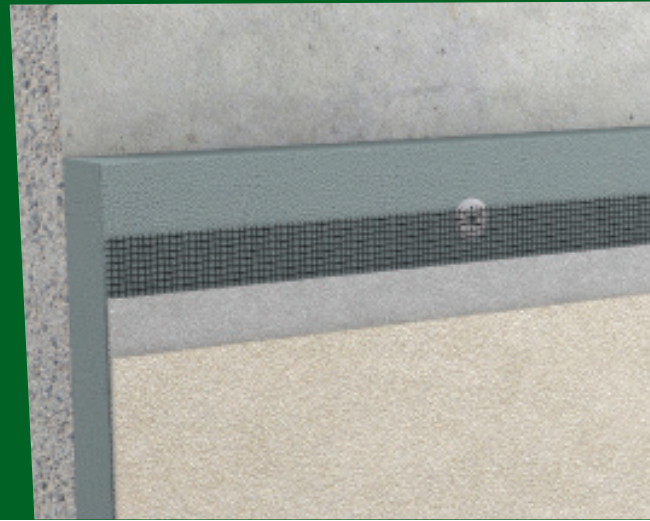

Xtratherm Warm-R is a high quality expanded Polystyrene containing integrated graphite within the cell structure that reflects and absorbs radiant heat resulting in an improved thermal insulation performance.

The Xtratherm EWB/EPSP is an Expanded Polystyrene with Graphite/Carbon Enhancement. The graphite particles act as infrared absorbers to reduce heat dissipation caused by the radiation. This improves the thermal conductivity of the board to 0.031 W/mK, an improvement on conventional expanded polystyrene products.

Application

Xtratherm EWB/EPSP provides thermal insulation to new and existing rendered or unrendered masonry.

(All surfaces should be sound)

Description

Xtratherm EWB/EPSP insulation board is suitable for mechanical fix to sound substrate using approved fixings at a specified rate per board. When considering use on uneven surfaces then bedding shall be required in accordance with the system specification.

Quality

Xtratherm EWB/EPSP range is manufactured to:

ISO 9001

Quality Management System

ISO 14001

Environmental Management System

Specification Clause

The wall insulation shall be Xtratherm Warm-R EWB/EPSP manufactured to EN13163 under ISO 9001: 2000 by Xtratherm, comprising a CFC/HCFC free graphite enhanced EPS __mm to achieve a U-value of __W/mK for the wall element. To be installed in accordance with instructions issued by Xtratherm. Refer to NBS clause E21 210 & 220.

Property & Units

Thermal Conductivity
0.031 (W/mK)

Length Tolerance
± 2mm

Width Tolerance
± 2mm

Thickness Tolerance
± 1mm

Flatness Tolerance
5mm

Squareness Tolerance
± 2mm / 1200mm

Dimensional Stability
DS(70,90)1

Compressive Strength
>70 (kPa)

Tensile Strength
>70 (kPa)

Fire Properties
Euroclass E

Warm-R EWB/EPSP

Length (mm)
1200

Width (mm)
600

Thickness (mm)
80 - 220

Warm-R EWB/EPSP

Typical R-values

80mm
R-value: 2.58

100mm
R-value: 3.23

120mm
R-value: 3.87

140mm
R-value: 4.52

220mm
R-value: 7.10

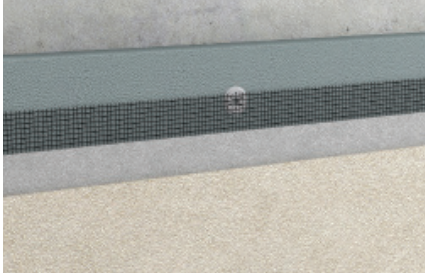

New Build

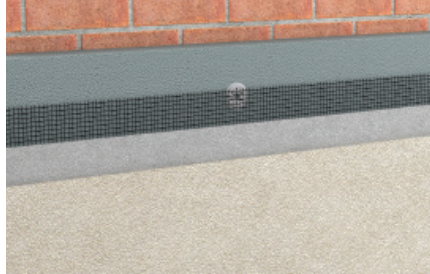

Refurbishment

U-values-External Wall Board (EPSP)

Wall Type	80mm	100mm	120mm	140mm	220mm
Cavity Empty	0.31	0.26	0.22	0.20	0.13
Cavity 50mm EPS	0.22	0.19	0.17	0.16	0.11
Hollow Block	0.33	0.27	0.23	0.20	0.13
Solid Block	0.32	0.27	0.23	0.20	0.13

EWB Standards & Thermal Conductivity

EPSP: EN13163: Thermal insulation products for buildings - Factory made products of expanded polystyrene (EPS) Specification. Warm-R Enhanced EPS has a thermal conductivity (90/90 value) of 0.031 W/m²K.

System Compatibility

Each EWI system supplier must refer to the published physical properties and standards to which Xtratherm EWB/EPSP is manufactured and take the necessary actions to establish the suitability for each specific systems application.

Quality Inspection

A visual check of each board must be conducted by suitably qualified/trained operative to ensure that wet or otherwise damaged boards are not installed.

QC Report Procedure

Xtratherm shall be notified in writing within 2 days of delivery should any concerns be identified. Failure to notify shall render any claims invalid.

Sitework

Insulated rendered systems are proprietary and use many different methods of fixing the EWB/EPSP to suitable substrates. Specific sitework guidance must be sought from the system manufacturer.

Daily Working Practice

At the end of each days work or upon interruption for extended periods of time the surface of all boards should be covered in order to protect from inclement weather.

Product Improvement

Xtratherm has a policy of continual product development and reserves the right to change the specification without prior notice.

Good workmanship and appropriate site procedures are necessary to achieve expected performance. The information contained in this data sheet is, to the best of our knowledge, true and accurate but any recommendations or suggestions which may be made are without guarantee since the conditions of use are beyond our control. Xtratherm reserve the right to change the content of this datasheet without prior notice.

Standards

Xtratherm EWB/EPSP range is manufactured to EN 13165 under quality systems approved to ISO 9001:2000 quality management, EN ISO 14001:2004 environmental management

Storage

Xtratherm EWB/EPSP must be stored on a firm, clean, level base off the ground and must be protected from prolonged sunlight. Care must be taken when moving or handling the insulation boards to avoid damage. The EWB/EPSP must not be exposed to naked flame or other ignition sources.

Cutting

Xtratherm EWB Boards can be readily cut using a sharp knife or fine toothed saw. Ensure tight fitting of the insulation boards to achieve continuity of insulation as asked for in accredited details.

Packaging

Xtratherm EWB/EPSP is wrapped in polythene packs and each pack is labelled with details of grade/type, size and number of pieces per pack.

Availability

Xtratherm products are available through builder's merchants and specialist distributors throughout the UK and Ireland. For the location of your nearest stockist contact Xtratherm.

CFC/HCFC Free

Xtratherm EWB/EPSP is manufactured without the use of CFC's or HCFC's and has Zero Ozone Depletion Potential with a GWP of less than 5.

Durability

Xtratherm EWB/EPSP is classified as a non-deleterious material and when correctly applied will last the life time of the rendering system.

Xtratherm Limited
Liscarton Industrial Estate
Kells Road, Navan
Co.Meath, Ireland

Xtratherm UK Limited
Park Road Holmewood
Chesterfield
Derbyshire S42 5UY

Tel
+ 353 (46) 906 6000
Fax
+ 353 (46) 906 6090

Tel
+ 44 (0) 371 222 1033
Fax
+ 44 (0) 371 222 1044

Contact
info@xtratherm.com

www.xtratherm.com