

Roll-Out Dry Ridge System - Ridge Union

CODE **GD RR-RU**

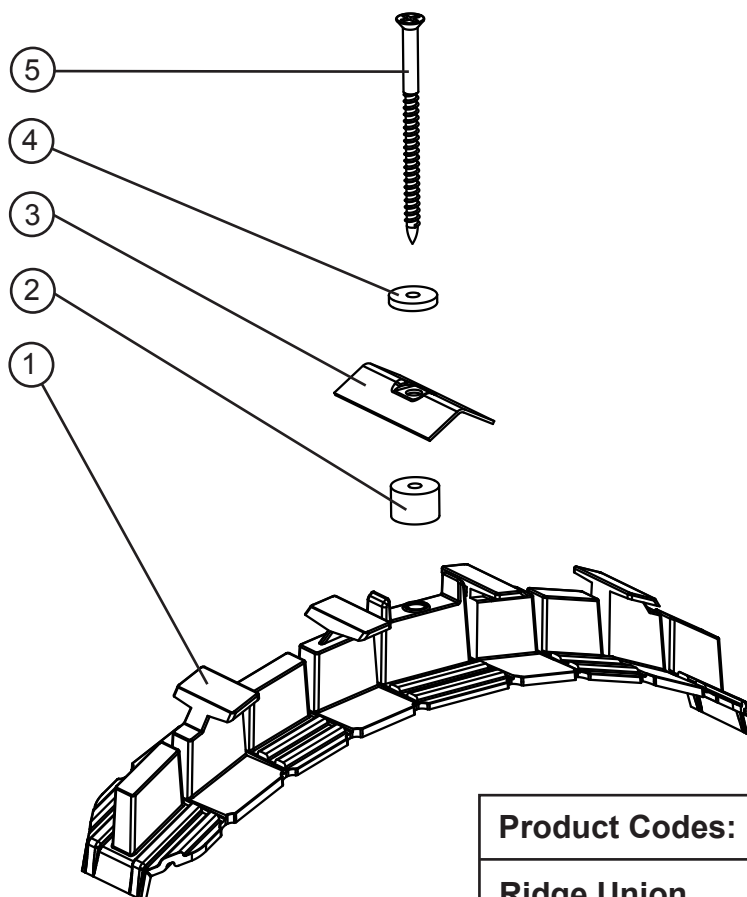

Product Codes:

Ridge Union

GD RR-RU

Description

The Ridge Union is made up of an assembly of parts, as shown in the diagram. The parts are as follows:

1. Ridge Union Body, injection moulded in UV stabilised polypropylene
2. Foam Washer, made from expanded polyethylene
3. Clamp, made from 304 grade stainless steel
4. Neoprene Rubber Washer
5. Countersunk Screw, made from 304 grade stainless steel

The Ridge Union is designed to sit in the gaps between each of the ridge tiles, holding them in place. The product slides onto the end of the ridge tile and is flexible so that it bends to the shape of the tile, both round and angled, and then the next ridge tile slots into the other side of the Ridge Union and this continues along the full length of the ridge. Once the ridge tiles are all correctly rested in place, the unions are secured by driving the countersunk screw, assembled with the washers and clamp, through the hole in the top and into the horizontal batten below. The screws should be tightened down so that the clamp presses down on the ridge tile securing it in position.

The Ridge Union forms part of Manthorpe's Dry Ridge System which can be purchased as a kit, with all the parts required to cover a run of approximately 6 metres.

MANTHORPE BUILDING PRODUCTS LTD
MANTHORPE HOUSE
BRITAIN DRIVE
CODNOR GATE BUSINESS PARK
RIPLEY
DERBYSHIRE DE5 3ND

TEL: 01773 514 200
FAX: 01773 514 262
EMAIL:
bpsales@manthorpe.co.uk
WEB
www.manthorpe.co.uk

DRN B.H.

Date 02/04/08

DRG No

Issue

The company maintains a policy of continuous development of its product range and reserves the right to amend the specification without notice.

MBP 8266
PAGE (1 OF 2)

D

Roll-Out Dry Ridge System - Ridge Union

CODE **GD RR-RU**

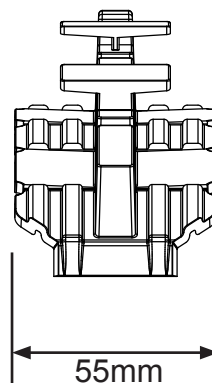
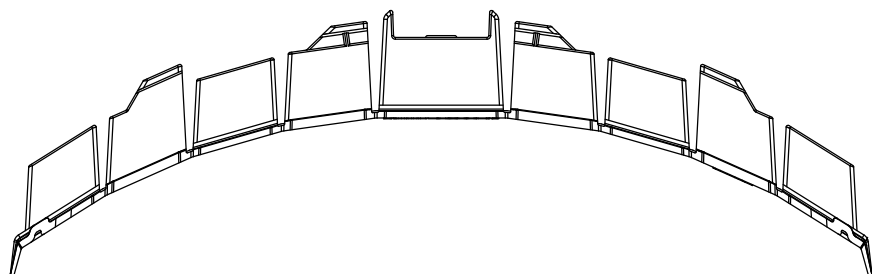
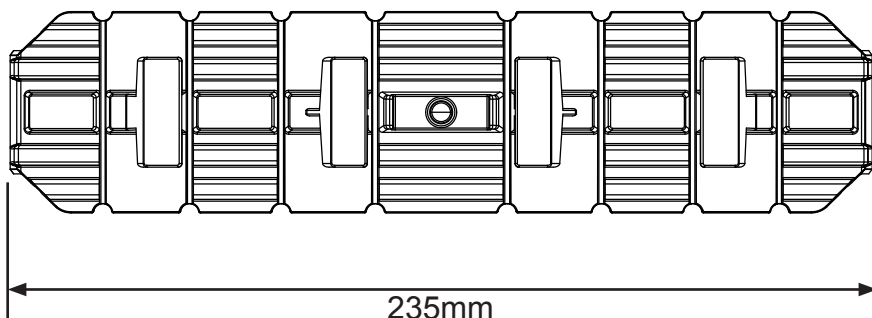

Fixing:

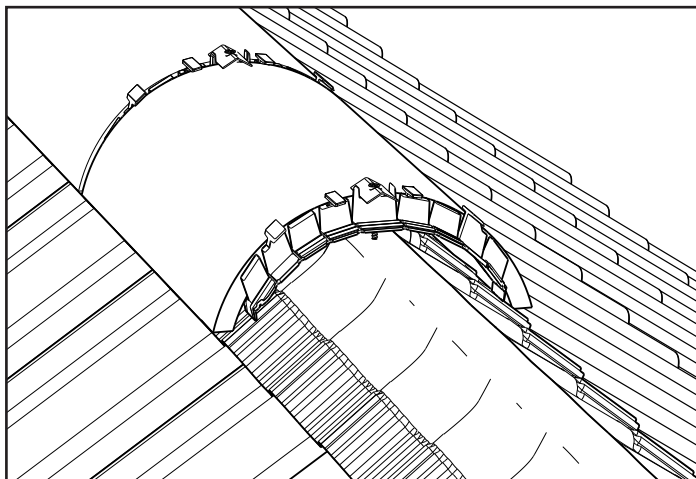

References

BSI: British Standard 5534:2003
BSI: British Standard 6399-2:1997
NHBC Standards Chapter 7.2

Roof Pitch Compatability	15° to 45° Pitch
Weight	0.066 kg each
Packaging	13 per roll-out system 12 per additional pack
Materials	UV Stabalised Polypropylene
Manufacturing Process	Injection moulded
Colour Variations	Black (BL) 

MANTHORPE BUILDING PRODUCTS LTD
MANTHORPE HOUSE
BRITAIN DRIVE
CODNOR GATE BUSINESS PARK
RIPLEY
DERBYSHIRE DE5 3ND

TEL: 01773 514 200
FAX: 01773 514 262
EMAIL:
bpsales@manthorpe.co.uk
WEB
www.manthorpe.co.uk

DRN B.H.

Date 02/04/08

The company maintains a policy of continuous development of its product range and reserves the right to amend the specification without notice.

DRG No

MBP 8266
PAGE (2 OF 2)

Issue

D